

CRNA GORA
Opština : Nikšić
Katastarska Opština : Stubica

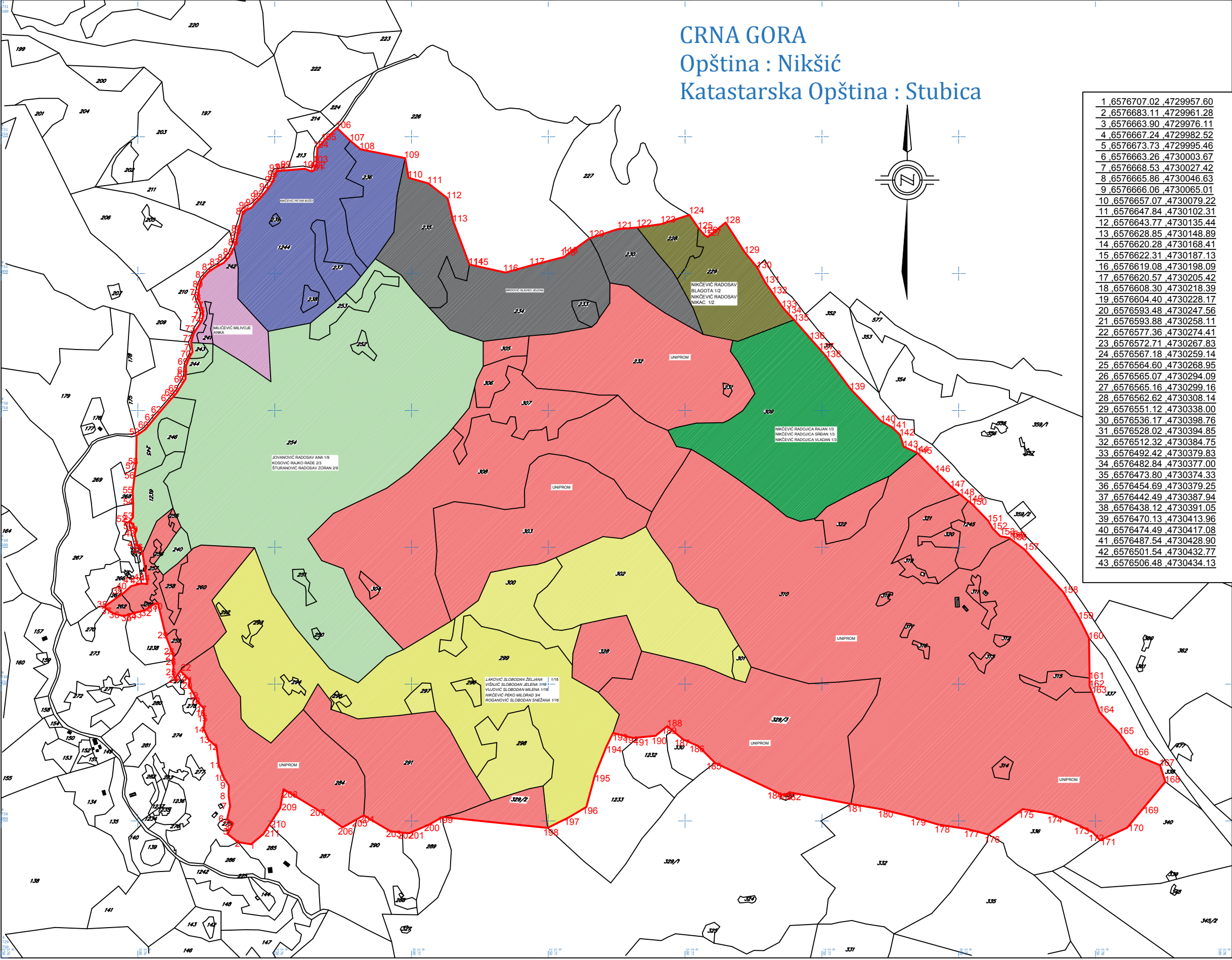

LOKALITET KONCESIJE: MEĐEĐE" - NIKŠIĆ	
PROSTORNO -PLANSKA DOKUMENTACIJA: PROSTORNI PLAN OPŠTINE NIKŠIĆ	
PARAMETRI PODRUČJA KONCESIJE:	
POVRŠINA: 154 96 76,90 m²	OBIM : 6044.47 m.
KOORDINATE GRANIČNIH TAČAKA PODRUČJA KONCESIJE	

1. 6576707.02 ,4729957.60	44. 6576517.36 ,4730432.75	128. 6577574.14 ,4731093.24
2. 6576683.11 ,4729961.28	45. 6576508.34 ,4730489.64	129. 6577609.30 ,4731038.45
3. 6576663.90 ,4729976.11	46. 6576503.55 ,4730502.87	130. 6577631.59 ,4731011.62
4. 6576667.24 ,4729982.52	47. 6576499.08 ,4730502.67	131. 6577646.39 ,4730983.99
5. 6576673.73 ,4729995.46	48. 6576494.16 ,4730521.87	132. 6577659.68 ,4730965.07
6. 6576663.26 ,4730003.67	49. 6576497.01 ,4730533.65	133. 6577677.43 ,4730939.84
7. 6576668.53 ,4730027.42	50. 6576491.75 ,4730535.88	134. 6577686.35 ,4730929.19
8. 6576665.86 ,4730046.63	51. 6576491.77 ,4730542.73	135. 6577699.38 ,4730915.53
9. 6576666.06 ,4730065.01	52. 6576483.37 ,4730546.18	136. 6577728.68 ,4730881.84
10. 6576657.07 ,4730079.22	53. 6576491.01 ,4730554.37	137. 6577745.45 ,4730862.86
11. 6576647.84 ,4730102.31	54. 6576491.21 ,4730580.06	138. 6577758.22 ,4730848.40
12. 6576643.77 ,4730135.44	55. 6576490.53 ,4730601.31	139. 6577802.19 ,4730789.43
13. 6576628.85 ,4730148.89	56. 6576493.77 ,4730628.18	140. 6577858.34 ,4730730.28
14. 6576620.28 ,4730168.41	57. 6576495.82 ,4730645.23	141. 6577878.15 ,4730719.44
15. 6576622.31 ,4730187.13	58. 6576496.68 ,4730652.34	142. 6577892.59 ,4730705.61
16. 6576619.08 ,4730198.09	59. 6576497.49 ,4730704.09	143. 6577899.43 ,4730683.85
17. 6576620.57 ,4730205.42	60. 6576514.15 ,4730715.90	144. 6577918.71 ,4730675.06
18. 6576608.30 ,4730218.39	61. 6576525.92 ,4730729.97	145. 6577924.86 ,4730672.02
19. 6576604.40 ,4730228.17	62. 6576537.54 ,4730743.82	146. 6577958.07 ,4730638.53
20. 6576593.48 ,4730247.56	63. 6576555.77 ,4730765.18	147. 6577985.15 ,4730611.63
21. 6576593.88 ,4730258.11	64. 6576563.99 ,4730774.34	148. 6578002.39 ,4730596.73
22. 6576577.36 ,4730274.41	65. 6576570.87 ,4730782.01	149. 6578017.45 ,4730584.64
23. 6576572.71 ,4730267.83	66. 6576581.22 ,4730798.79	150. 6578024.66 ,4730578.86
24. 6576567.18 ,4730259.14	67. 6576587.01 ,4730807.61	151. 6578054.07 ,4730548.15
25. 6576564.60 ,4730268.95	68. 6576587.23 ,4730815.18	152. 6578062.29 ,4730534.27
26. 6576565.07 ,4730294.09	69. 6576587.69 ,4730831.02	153. 6578076.50 ,4730520.14
27. 6576565.16 ,4730299.16	70. 6576593.20 ,4730844.81	154. 6578092.16 ,4730517.55
28. 6576562.62 ,4730308.14	71. 6576599.83 ,4730856.89	155. 6578094.48 ,4730515.65
29. 6576551.12 ,4730338.00	72. 6576597.19 ,4730873.79	156. 6578097.46 ,4730513.22
30. 6576536.17 ,4730398.76	73. 6576601.99 ,4730890.70	157. 6578120.01 ,4730496.25
31. 6576528.02 ,4730394.85	74. 6576612.80 ,4730907.50	158. 6578191.48 ,4730417.67
32. 6576512.32 ,4730384.75	75. 6576617.38 ,4730914.66	159. 6578219.68 ,4730371.35
33. 6576492.42 ,4730379.83	76. 6576619.53 ,4730924.00	160. 6578238.18 ,4730334.24
34. 6576482.84 ,4730377.00	77. 6576617.28 ,4730934.50	161. 6578239.26 ,4730260.92
35. 6576473.80 ,4730374.33	78. 6576612.47 ,4730948.40	162. 6578239.47 ,4730246.26
36. 6576454.69 ,4730379.25	79. 6576609.48 ,4730954.92	163. 6578243.64 ,4730235.36
37. 6576442.49 ,4730387.94	80. 6576610.99 ,4730970.64	164. 6578257.64 ,4730198.80
38. 6576438.12 ,4730391.05	81. 6576616.04 ,4730988.48	165. 6578293.80 ,4730160.08
39. 6576470.13 ,4730413.96	82. 6576628.14 ,4731002.55	166. 6578321.01 ,4730121.29
40. 6576474.49 ,4730417.08	83. 6576641.82 ,4731011.52	167. 6578367.94 ,4730101.92
41. 6576487.54 ,4730428.90	84. 6576656.53 ,4731019.74	168. 6578377.90 ,4730071.70
42. 6576501.54 ,4730432.77	85. 6576666.80 ,4731030.14	169. 6578334.87 ,4730020.17
43. 6576506.48 ,4730434.13	86. 6576675.88 ,4731047.82	170. 6578307.94 ,4729987.72
	87. 6576680.03 ,4731059.77	171. 6578258.57 ,4729964.97
	88. 6576681.85 ,4731072.65	172. 6578245.31 ,4729979.12
	89. 6576692.04 ,4731112.45	173. 6578218.57 ,4729992.39
	90. 6576695.69 ,4731115.20	174. 6578169.11 ,4730012.98
	91. 6576707.87 ,4731120.56	175. 6578117.07 ,4730021.58
	92. 6576716.85 ,4731131.91	176. 6578054.52 ,4729975.33
	93. 6576721.76 ,4731135.88	177. 6578016.48 ,4729984.93
	94. 6576732.95 ,4731148.92	178. 6577962.64 ,4729993.57
	95. 6576742.89 ,4731162.22	179. 6577918.93 ,4730006.19
	96. 6576747.93 ,4731172.07	180. 6577859.26 ,4730021.44
	97. 6576750.98 ,4731183.50	181. 6577803.01 ,4730031.16
	98. 6576754.93 ,4731187.28	182. 6577690.78 ,4730052.42
	99. 6576769.88 ,4731188.35	183. 6577684.76 ,4730048.13
	100. 6576804.88 ,4731191.42	184. 6577676.77 ,4730047.94
	101. 6576818.02 ,4731186.15	185. 6577554.56 ,4730106.41
	102. 6576822.61 ,4731190.08	186. 6577523.99 ,4730137.18
	103. 6576826.66 ,4731201.69	187. 6577496.80 ,4730148.69
	104. 6576827.92 ,4731228.30	188. 6577476.93 ,4730165.35
	105. 6576840.80 ,4731243.33	189. 6577467.73 ,4730173.06
	106. 6576863.70 ,4731265.87	190. 6577446.02 ,4730155.71
	107. 6576888.68 ,4731242.33	191. 6577413.70 ,4730152.39
	108. 6576906.99 ,4731227.05	192. 6577405.34 ,4730151.53
	109. 6576988.57 ,4731211.11	193. 6577368.23 ,4730160.59
	110. 6576994.58 ,4731174.75	194. 6577356.00 ,4730135.12
	111. 6577030.72 ,4731164.90	195. 6577334.77 ,4730082.21
	112. 6577065.97 ,4731137.33	196. 6577319.51 ,4730025.59
	113. 6577076.58 ,4731094.30	197. 6577287.40 ,4730006.58
	114. 6577106.04 ,4731016.48	198. 6577248.73 ,4729987.44
	115. 6577114.93 ,4731014.50	199. 6577056.94 ,4730007.32
	116. 6577172.02 ,4731001.77	200. 6577031.43 ,4729992.87
	117. 6577216.44 ,4731014.42	201. 6576995.19 ,4729977.67
	118. 6577279.54 ,4731030.57	202. 6576983.50 ,4729978.87
	119. 6577282.29 ,4731033.19	203. 6576961.53 ,4729981.12
	120. 6577325.71 ,4731064.48	204. 6576912.89 ,4730010.29
	121. 6577376.79 ,4731081.15	205. 6576900.09 ,4730003.01
	122. 6577412.07 ,4731084.21	206. 6576874.05 ,4729988.20
	123. 6577456.05 ,4731090.32	207. 6576827.00 ,4730021.49
	124. 6577507.93 ,4731107.22	208. 6576766.09 ,4730058.00
	125. 6577524.19 ,4731083.51	209. 6576760.22 ,4730023.96
	126. 6577535.25 ,4731070.58	210. 6576740.49 ,4729993.24
	127. 6577541.70 ,4731066.54	211. 6576729.51 ,4729976.14